



Capacitive sensors Series 40 - NAMUR

Housing M18 x 1

- Ex II 2 G EEx ia IIC T1-T6
- Ex II 1D IP67 T101°C
- Housing material: PTFE
- For use in areas where there is a risk of explosion
- Ideal for detection of chemically aggressive media
- Suitable for food applications
- Non-Flush mountable
- Sensing distance 2...10 mm adjustable

Certificate: DMT 01 ATEX E 157
DMT 03 ATEX E 048



Technical data

Operating distance S_n [mm], flush mounting	8, no
Operating distance min./max. [mm] adjustable	2...10
Electrical version	2-wire DC
Output function	NAMUR DIN 60947-5-6
Type	KAS-40-A23-N-K-PTFE-StEx-N, ATEX
Art.-No.	KA 0282
Connection diagram No.	see below
Operating voltage (U_B)	$U_i = 15 \text{ V DC}$
Output current active surface free	< typ. 1.5 mA
Output current active surface covered	> typ. 3 mA
Self-inductance (L)	0.2 mH
Self-capacitance (C)	250 nF
Permitted residual ripple max.	5%
Frequency of operating cycles max.	50 Hz
Permitted ambient temperature	-25...+70°C
LED-display	yellow
Degree of protection IEC 529	IP 67
Connection cable	2 m 2 x 0.34 mm ²
Housing material	PTFE
Active surface	PTFE
Lid	PC

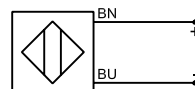
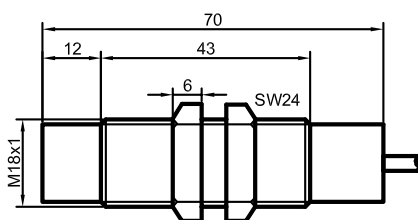

All specifications are subject to change without notice. (25-04-2006)